



Installation Manual INE-W928R Kit

- Fiat Ducato 2011 -> (Type 280* / 290* facelift) Colour: piano-black
Not for models with SONY OEM head unit Part-No.: KIT-8DUC

Compatible with these Alpine navigation devices

INE-W928R

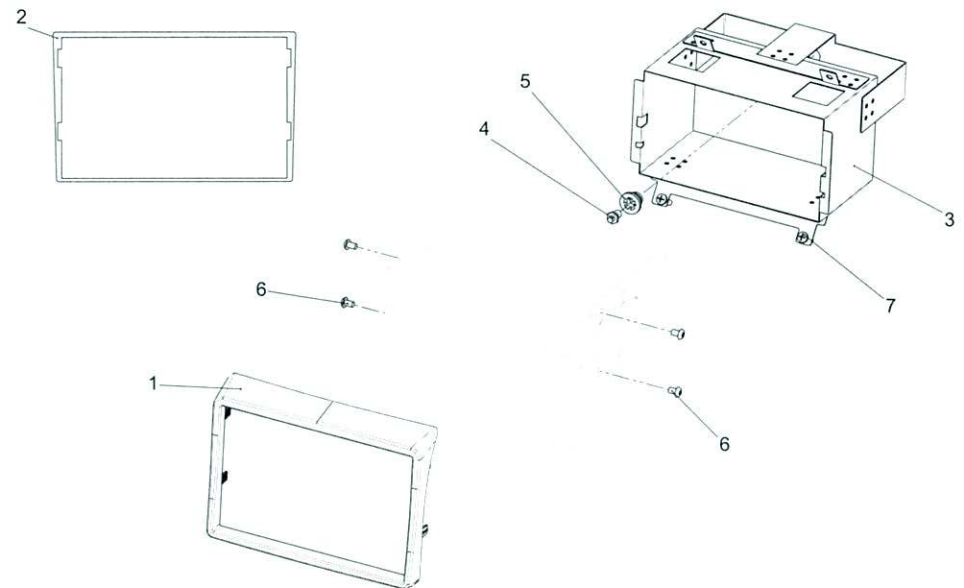

- (1) Facia Plate
- (2) Cut Tool
- (3) Sheet Metal Frame
- (4) SnapLoc Stud
- (5) SnapLoc coupling
- (6) flat headed screw
- (7) self-tapping convex fillister head screw

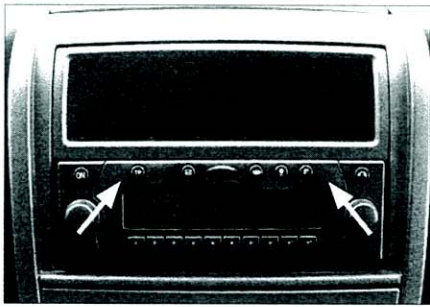

1. Remove OEM head unit and pocket

Special tools like radio release keys may be required.

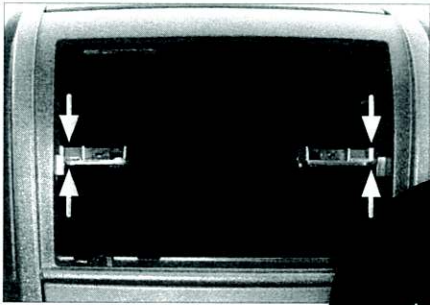

2. Cut away original brackets (marked with arrows) with appropriate tools to clear space

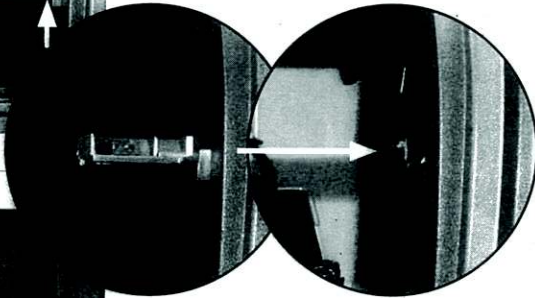

3. Ducato dashboard after cutting away brackets



4. Cut away plastic here in order to clear space for INE-W928R
See sample photos at the right for details

CAUTION: Don't cut until the edge of the frame because the gap can not be covered afterwards

Use included cut tool and mark (see white line) the area for cutting

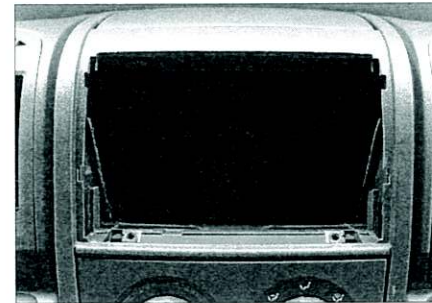

5. Ducato dashboard after plastic was cut away

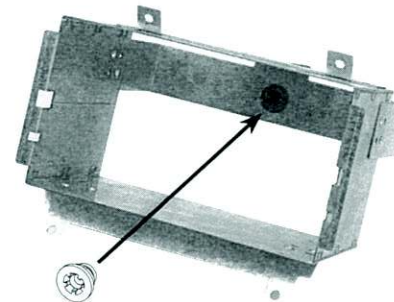

6. Prepare metal frame:

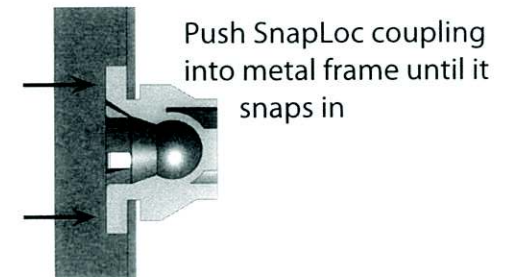

Push SnapLoc coupling into metal frame until it snaps in

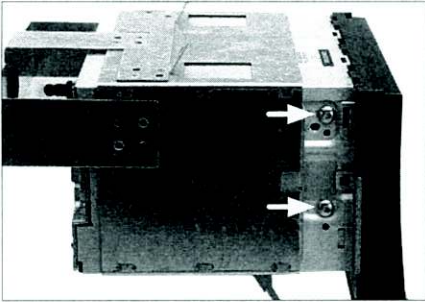

7. Preparation: In order to make sure the fascia plate can be attached to metal frame please follow the next steps:

Attach four M5x6 screws to INE-W928R (two on each side)

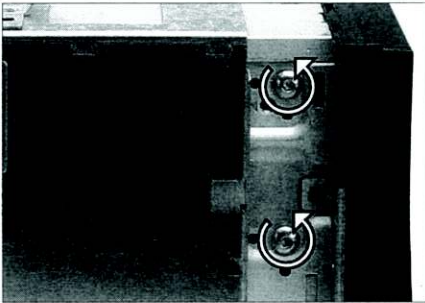

8. Lose screws again for app. a three quarter turn

The screws are bending the metal frame a bit in order to make the fascia plate clip properly

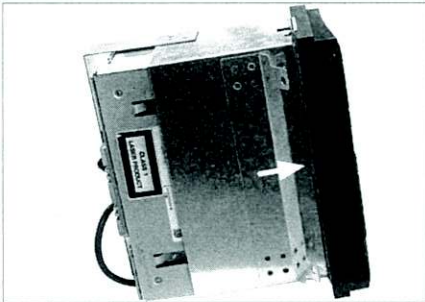

9. Push metal frame over INE-W928R until it closes seamlessly

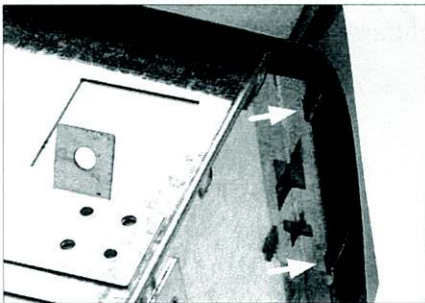
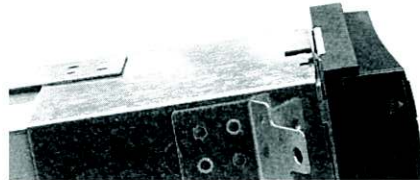

10. Place fascia plate until it snaps in

If the fascia doesn't clip return to picture 8 until it clips

Remove fascia plate and metal frame again

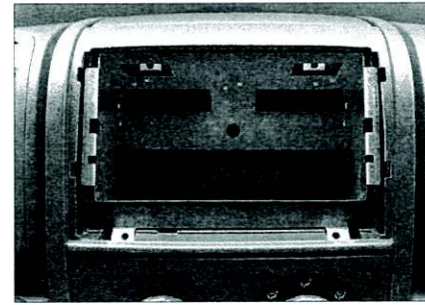

11. Mount metal frame to dashboard and fix it

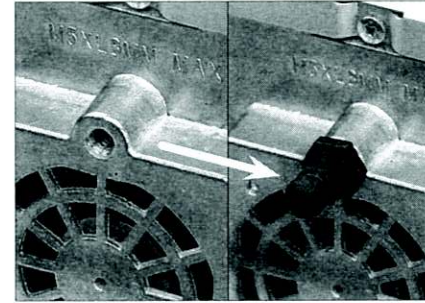

12. Mount SnapLoc Stud at rear side of Alpine INE-W928R

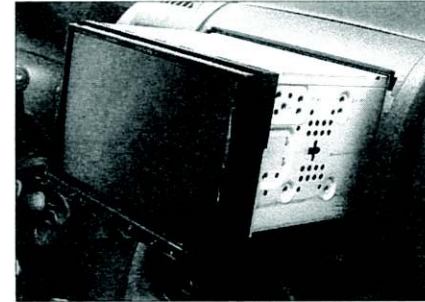

13. Connect all required circuit points and push Alpine INE-W928R into metal frame until it snaps in

(SnapLoc stud on rear side has to snap into SnapLoc coupling)



14. Mount fascia plate to finish installation

All installation work must be performed by a qualified professional installer only. The manufacturer / dealer is not liable for any kind of incidental or indirect damages.